

## KÖR FLANŞ PN 6



TS EN 1092 - 1 + A1 TİP 5  
DIN 2527 PN 6



**E.M.P.**  
www.emp.com.tr  
www.empflans.com

## BLIND FLANGE PN 6



EN 1092 - 1 + A1 TYPE 5  
DIN 2527 PN 6

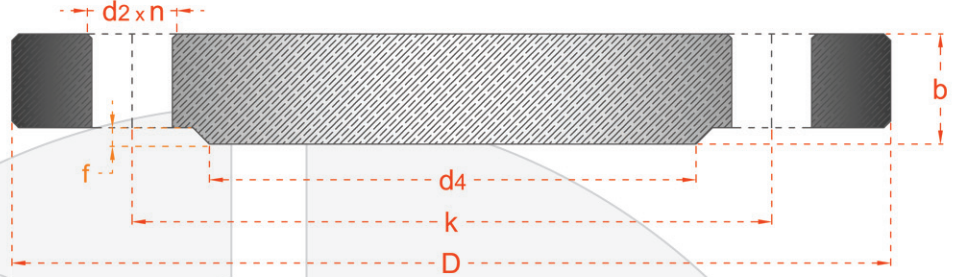

BORU/PİPE DN	FLANŞ /FLANGE D		ALIN/ RAISED FACE b		DELİKLER/DRILLINGS d <sub>4</sub> f k n			AĞIRLIK WEIGHT DIN /kg		
	EN 1092-1	DIN	d <sub>4</sub>	f	k	n	vida/screw	d <sub>2</sub>	DIN /kg	
10	75	12	12	35	2	50	4	M10	11	0.35
15	80	12	12	40	2	55	4	M10	11	0.43
20	90	14	14	50	2	65	4	M10	11	0.56
25	100	14	14	60	2	75	4	M10	11	0.70
32	120	14	14	70	2	90	4	M12	14	1.17
40	130	14	14	80	2	100	4	M12	14	1.39
50	140	14	14	90	2	110	4	M12	14	1.62
65	160	14	14	110	2	130	4	M12	14	2.15
80	190	16	16	128	2	150	4	M16	18	3.43
100	210	16	16	148	2	170	4	M16	18	4.22
125	240	18	18	178	2	200	8	M16	18	5.42
150	265	18	18	202	2	225	8	M16	18	7.50
200	320	20	20	258	2	280	8	M16	18	12.30
250	375	22	22	312	2	335	12	M16	18	18.54
300	440	22	22	365	2	395	12	M20	22	25.46
350	490	22	22	415	2	445	12	M20	22	31.75
400	540	22	22	465	2	495	16	M20	22	38.48
450	595	24	24	520	3	550	16	M20	22	51.20
500	645	24	24	570	3	600	20	M20	22	60.10
600	755	30	24	670	3	705	20	M24	26	82.30
700	860	40	24	775	3	810	24	M24	26	106.98
800	975	44	24	880	3	920	24	M27	30	137.40
900	1075	48	26	980	3	1020	24	M27	30	181.70
1000	1175	52	26	1080	3	1120	28	M27	30	217.16
1200	1405	60	28	1295	5	1340	32	M30	33	334.50
1400	1630	68	32	1510	5	1560	36	M33	36	514.70
1600	1830	76	34	1710	5	1760	40	M33	36	690.80
1800	2045	84	36	1920	5	1970	44	M36	39	912.90
2000	2265	92	38	2125	5	2180	48	M39	42	1,181.00

Ölçüler mm olarak verilmiştir.  
Çelik ve paslanmaz üretilebilir.

Dimensions are in mm.  
Steel and stainless steel can produce.